

15F2918

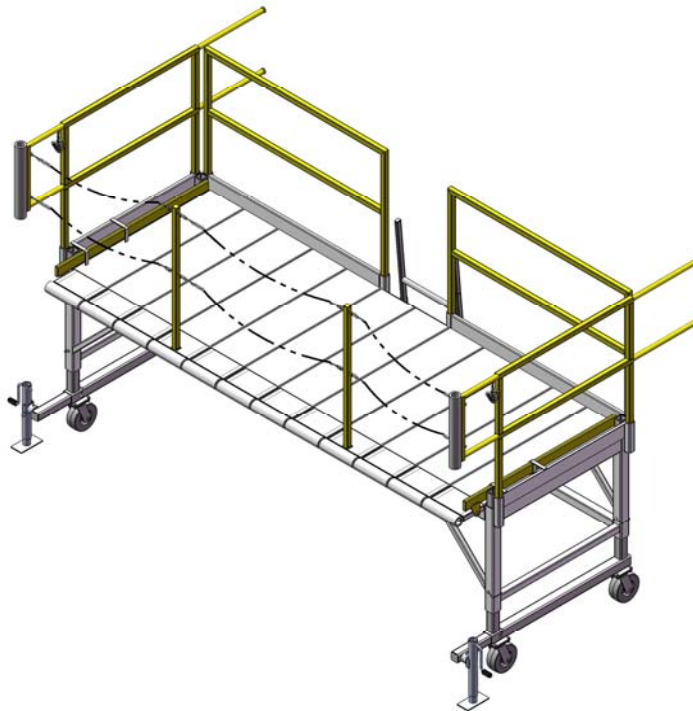

Maintenance Stand



Building Quality Ground Support Products Since 1961

- Morton tread Grip Decking
- 1000 lb capacity
- Adjustable to any height within 52.375" to 72.375" in 5" increments
- Forklift pockets integrated in frame
- All-steel, welded construction
- Adjustable pullout planks
- Adjustable pullout handrails
- Adjustable pullout stabilization jacks
- Epoxy powder coat

CLYDE

Clyde Machines
P.O. Box 194
1150 Hwy 55 N.
Glenwood, MN 56334 USA
(320) 634-4504
(320) 634-4506 Fax

www.clydemachines.com

15F2918

Maintenance Stand

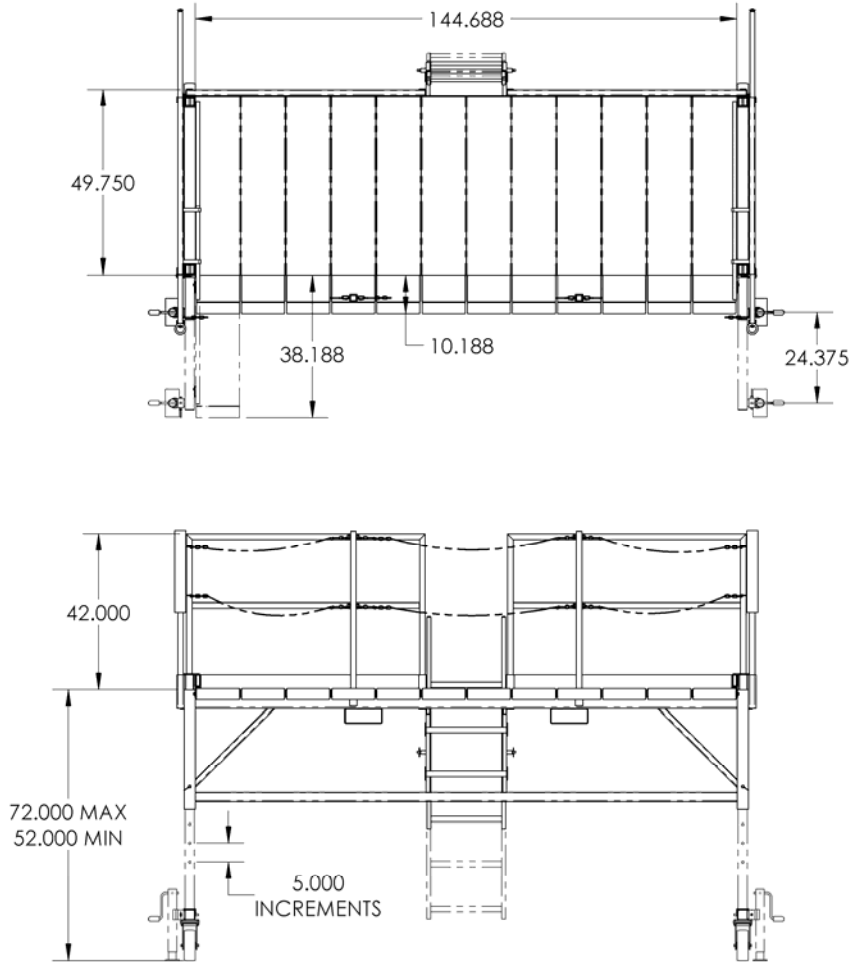

Shipping Information

- Capacity - 1000 lbs
- Platform Height - 52.375" - 72.375"
- Weight of stand - 1800 lbs
- Shipping dimensions
 - Width - 68"
 - Height - 95"
 - Length - 159"

CLYDE

Clyde Machines
P.O. Box 194
1150 Hwy 55 N.
Glenwood, MN 56334 USA
(320) 634-4504
(320) 634-4506 Fax

www.clydemachines.com